

## 2019 Hylas 48

\$0 tax not paid

**NEW BUILD OPTION - price including delivery**



### General Information

<b>Manufacturer/Model</b>	Hylas 48
<b>Designer</b>	Dixon Design
<b>Year</b>	2019
<b>Category</b>	Sail
<b>New or Used</b>	Used
<b>Sale Status</b>	Available
<b>Price</b>	\$0
<b>Tax/VAT Status</b>	Tax not paid
<b>Lying</b>	Southampton - other locations on request, United Kingdom
<b>Reference</b>	1528843

## Specifications

<b>LOA</b>	14.63m
<b>LWL</b>	12.89m
<b>Beam</b>	4.42m
<b>Draft</b>	1.98m
<b>Displacement</b>	17644kg
<b>Engine</b>	Yanmar 75hp
<b>Fuel</b>	diesel
<b>Fuel Capacity</b>	1100l
<b>Hull Construction</b>	GRP
<b>Keel Type</b>	Fin Keel
<b>Berths</b>	8
<b>Cabins</b>	3
<b>Drinking Water Capacity</b>	451l

## Description

### BRAND OVERVIEW

Hylas Yachts is a brand synonymous with quality, support and service. The Hylas Yachts team are dedicated to bringing distinctive cruising yachts to a global audience. The Hylas Yachts brand is the cornerstone of Queen Long Marine; one of the longest established and best-known yacht builders in Asia. With representatives in Europe and America, working closely with their clients and with design input from some of the world's greatest yacht designers, over 500 Hylas yachts are now afloat in all hemispheres.

Whether you have a clear idea of exactly what you want, or if you require some help and assistance, you can rely upon the service and support that comes with being a Hylas Yacht owner. The service does not stop when your Hylas Yacht is delivered. The Hylas Yachts mission is to provide a complete ownership experience from order, design, build, support and resale.

With lines from some of the best yacht designers in the world, and equipped and fitted out to each individual's specifications, a Hylas Yacht allows her owner to imagine and then live their own cruising lifestyle without compromise.

### BUILDER'S HISTORY

The Queen Long Marine shipyard was founded in 1978 by the Huang family and remains in full family operation and ownership to this. Based in Kaohsiung, the yacht-building capital of Taiwan, the 117,300 sq ft shipyard is home to a 32,000 sq ft main construction hall, dedicated 18,000 sq ft laminating hall, a large paint facility, extensive design and administration offices and their famous on-site 3m-deep full-sized yacht testing tank complete with a thriving population of ornamental Koi Carp. A team of around 100 highly skilled shipwrights, laminators, engineers, electricians and painters are employed directly by the shipyard to build the Hylas Yachts range of sailing and motor yachts.

The Hylas Yachts brand established by Queen Long Marine in 1985 has rapidly become associated with the production of the highest quality blue water performance sailing yachts and motor yachts from some of the most iconic naval architects including German Frers, Sparkman & Stephens, Dixon Design, Dean Salthouse and top interior design firms like HotLab of Italy.

### HYLAS YACHTS AND GRABAU INTERNATIONAL

Grabau International are delighted to offer the Hylas range of performance blue water cruising yachts and motor yachts as exclusive sales agent for the marque in Europe working in partnership with Hylas Yachts Ltd. All Hylas Yachts can be easily customised to their owners' personal wishes. Very few builders in the world today allow owners this level of freedom to customise interiors or develop upgraded to their own liking.

### HYLAS 48 standard specification

Price shown is for a standard specification without options, but including shipping and commissioning to UK. Other locations available on request.

**\*\* PLEASE NOTE –** The specification below is for a standard build. The Hylas 48 is very much a semi-custom build, with each yacht tailored to the specification of her owner. To discuss your precise specification and layout requirements, please contact us.\*\*

### PERFORMANCE

New in its class, the Dixon Hylas 48 was precisely engineered for strength and reliability to satisfy even the most demanding buyer.

This stately yacht is powerful but graceful which includes sleek raised salon windows for easy viewing, the choice of two or three cabins and a large center cockpit vessel that will impress any guest. The Hylas 48 offers premium quality and handcrafted details that make this luxury yacht stand in a class of it's own.

## DESIGNED WITH PRECISION

- Expansive cockpit for relaxation as the helmsperson enjoys the balanced wheel
- Expansive uncluttered deck space
- Large salon with iconic styling and sleek raised windows for easy viewing
- Comfortable seating with custom interiors
- Plenty of storage providing versatility and function
- Interior is bright and well appointed with evident Hylas trademark craftsmanship
- Choose from two or three comfortable cabins built to suit owner's personal taste

## Specification

### HULL & DECK

- Solid hand-laid fiberglass lay up with no core and using vinylester resins and Isophthalic Gel-coat
- Hull is laid up with two layers of epoxy barrier coats below the waterline for optimal protection
- Three coats of bottom paint
- Watertight collision bulkhead forward of forward cabin with independent overboard drainage
- Watertight stern section across aft lazarettes and stern locker
- Divided anchor locker with separate locker for fenders and warps
- Large aft stern lazarettes port and starboard with secure locking latches
- Secure locks to be supplied for deck area
- Stern locker with dedicated auto bilge pump plus manual over-ride in cockpit
- Solid lead keel, deep draft
- Semi-skegged rudder for optimal performance, strength and protection
- Bottom of rudder plane above the keel plane for grounding safety
- Solid GRP fiberglass in all areas for deck fittings and high-stress areas
- Moulding contrast on non-skid areas available in grey, beige or white
- Solid stainless stem head fitting with split bow roller for stowage for two anchors
- Solid stainless steel striker plates for bow protection
- Salt water wash-down pump for deck and anchor cleaning
- Two pairs of stainless steel bow cleats, one pair of 12" amidships cleats and one pair of 12" stern cleats
- 27" high stanchions with double lifelines
- Side boarding ladder with port and starboard mounting brackets
- ManShip 316 stainless hatches and windows, overhead and ports throughout with mosquito screens
- Lewmar winch inventory
- 58ST Primary winches
- 48ST Secondary winches
- 48ST Cockpit winch
- 48ST Halyard winches x 2 for mast
- Genoa deck blocks
- Teak handrails on foredeck coach roof and aft coach roof
- Stainless steel companionway handrails
- Whitlock pedestal with offset pedestal for instrument mounting
- Mamba solid rod steering
- Lewmar pedestal compass
- Teak cockpit table with drinks holder
- Solid stainless steel cowl vents, two forward and two aft
- Stainless steel protective stern plate
- Fresh water hot and cold shower built in transom area
- Fold-down stainless steel stern boarding ladder
- Inner forestay chain plate for optional inner stay
- Self tacking (track optional)
- Cockpit cushions dark blue with white piping
- Working genoa
- Primary and secondary genoa halyard
- Primary and secondary main halyard

### GROUND TACKLE

- Lewmar V4 windlass with chain feed stainless plate for chain protection plus
- bow control and cockpit control
- Primary Delta anchor and 90m of 3/8" galvanized chain
- Fore and aft mooring lines
- Fenders x 6

## RIG & RIGGING

- Deck collar and base for mast and electric control motor for inmast furling if fitted
- Standard anodized aluminum mast
- Three-spreader rig
- Forward and aft lowers for rig stability
- Sta-lock standing rigging
- Roller furling twin grooved forestay
- Standard mainsail

## MECHANICAL/ELECTRICAL

- Yanmar 75 HP sail drive 4 cylinder turbocharged diesel engine with cockpit controls and alarm systems
- Morse single control lever mounted on pedestal
- Dual Racal fuel filtration system allowing independent filter and bypass
- Walborough in-line fuel system allowing engine bypass for filtration and eliminating the need for future engine bleeding in the case of a dry fuel tank
- Oil change electric pump for engine and optional generator if fitted
- PSS shaft seal if not using sail drive
- All wire is tinned from the factory; no copper wire used
- All through hull fittings are solid bronze and are all bonded Groco Type
- Two copper strips running bow to stern both port and starboard for grounding
- Three AGM 8D house batteries
- AGM engine starting battery
- AGM anchor windlass battery
- All batteries are isolated with built-in reverse isolation switch
- Two independent 80A alternators, one dedicated to house bank and one to engine start
- All batteries self-contained, strapped and secured
- Engine room sound insulation fire retardant and CE approved
- Shore power connector 32A 220v
- 46 litre hot water tank 220v AC
- 40A built-in battery charger
- Engine room extractor fan
- Navigation lights and running lights stern and bow
- Automatic engine room fire extinguisher
- AM/FM cabin radio
- 4 interior speakers and 2 cockpit speakers
- Two independent bilge pump systems

## PLUMBING AND TANKAGE

- 451 litres total water tankage in two independent stainless steel tanks.
- 1100 litres of fuel in four independent aluminum alloy fuel tanks all pressure tested
- Fuel manifold changeover system
- Option available to increase and/or change the fuel/water ratio
- All tanks have easy access for inspection with dipstick
- Sludge removal tap and pipe at bottom of each tank
- Threaded inspection cap and larger inspection port
- Baffle plates fitted where required
- Two independent fresh water pump systems DC 12v
- Third manual fresh water pump foot-activated for fresh water
- Large holding tank for both heads
- 46 litre hot water heater heated via engine-driven system or AC supply
- All through-hull fittings are bronze with sea cocks or valves and are bonded

## INTERIOR

- We offer owners a unique opportunity to customize their interiors to a level that few builders allow
- In addition, many of these changes cost very little or nothing and increase the value considerably
- Customized teak interior
- Solid teak and holly soles laid on subflooring with epoxy urethane coating and seven layers of varnish
- Solid teak doors and trim
- Finely finished cabinetry with a choice of solid or louvered finish
- Abundant overhead hatches and ports for excellent ventilation
- Epoxy sealed engrains and subflooring
- All cabin sole pieces are positive locking for offshore passage making
- All cabinets are completed throughout including complete interiors
- All overhead headlining is easily removed

## GALLEY

- Long extended galley offering total safety with room to brace on either tack while sailing offshore
- Ample cabinets, storage lockers and drawers for cutlery, cookware and food storage
- Slide-out waste container with positive locking door
- Force 10 three-burner cooker with Xintex propane monitor and two sensors

- Large Frigo-0-Boat freezer/refrigeration system with thermostatic controls and temperature gauges
- Freezer/refrigeration boxes have electric pumps for drainage and are both top and front opening
- Counter top recesses over stove allowing for stainless steel backsplash and increasing counter space when in place
- Manual foot pump for fresh water at sink
- Counter tops as per samples; Whalee tops locally made

#### NAVIGATION STATION

- Forward facing Nav station with full-size table to hold half-folded admiralty charts
- Owners may customize table, drawers, instrument repeater panel to their liking
- Radar box custom built to fit owner's choice of radar
- Access to complete wiring harness and breakers
- All instruments and systems well labelled inside and out and traced numerically

#### FORWARD CABIN & HEADS

- Full-length double berth with split mattress, shelves above and hanging locker space
- Mirror, drawers and cupboard space
- Mirror-faced cupboard in heads
- Jabsco manual flush heads
- 90 litres for holding tank with dual Y valve system for deck pump-out and direct pump-out overboard with independent hand pump

#### AFT STATEROOM & OWNERS HEAD

- Large aft berth set on centre line with split mattress and starboard side settee
- Hanging style lockers with removable shelves
- Port side vanity unit with fold-up mirror

#### MAIN SALOON

- Solid teak dinette table with cupboard pedestal under
- All tankage is below cabin sole for good weight distribution
- Custom TV hoist can be fitted on port side for 20" TV
- Built-in cocktail cabinet
- Bench extendable for extra seating around dinette table
- Extra storage area under seating

#### PORT SIDE CABIN

- Port side cabin offers versatility as private double guest room or as crew quarters with an upper and lower berth
- Hanging locker with mirror

## Viewing arrangements

Lying – NEW BUILD OPTION

Tel: +44 (0)1590 673715 Email: [hylasyachts@grabauinternational.com](mailto:hylasyachts@grabauinternational.com)

### Please note.

Contracts to purchase, commissioning (in Southampton - UK) will be supplied by Hylas Yachts Ltd – official importer of Hylas Yachts to Europe. Warranty will be supplied by Queen Long Marine Ltd (Hylas Yachts) as builders.

All information, explanations and illustrations contained in these pages are based on the product information available at the time of publication. Hylas Yachts Ltd, Grabau International Limited and Queen Long Marine Ltd reserve the right to modify, delete, substitute, at any time, any equipment without prior notice.



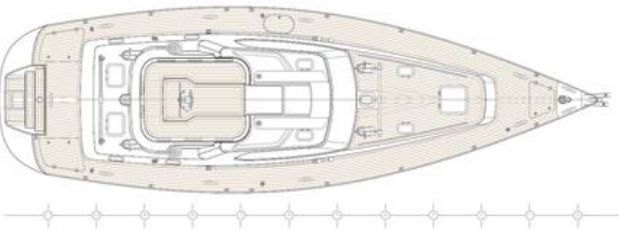
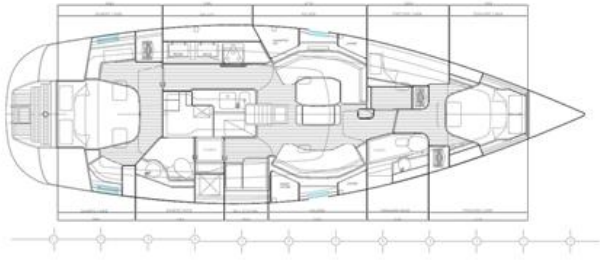













---

*Grabau International offers the details of all vessels in good faith but cannot guarantee or warrant the accuracy of this information or warranty the condition of any vessel and the details do not constitute a part of any contract. A buyer should instruct his agents, or his surveyors, to investigate such details as the buyer desires validated. All vessels are offered subject to prior sale, price change, or withdrawal without notice. Grabau International provides professional yacht conveyancing and legal transfer of title for all yachts as per the ABYA Code of Practice with all deposit payments and final balance payments processed through secure dedicated client accounts solely for that purpose. Our dedicated client accounts are written in trust at Natwest Bank and we are fully insured.*