

2020 Sanlorenzo SL 78

€4,200,000 tax not paid

Great spec, nearly-new SL78



General Information

Manufacturer/Model	Sanlorenzo SL 78
Designer	Sanlorenzo
Year	2020
Category	Power
New or Used	Used
Sale Status	Available
Price	€4,200,000
Tax/VAT Status	Tax not paid
Lying	La Spezia, Italy
Reference	2042122

Specifications

LOA	24.64m
LWL	19.55m
Beam	5.74m
Draft	1.8m
Displacement	70000kg
Engine	2 x MTU M96L 10V 2000
Engine Hours	680
Fuel	diesel
Fuel Capacity	5350l
Max Speed	55.56kph
Range	583km
Hull Construction	GRP
Berths	8
Cabins	4
Drinking Water Capacity	1400l

Description

Rare to the market, lightly used build example of the hugely popular Sanlorenzo SL78 launched in 2020. Run by a professional crew of 3. Licensed for Charters. Italian flagged

FURTHER BROKER'S COMMENTS:

Lightly used and beautifully presented example of Sanlorenzo SL 78 from 2020 this stunning brand-new yacht boasts a fantastic specification including: -

- Planing hull with 30 knot performance potential
- Air-conditioning all through
- Bow and stern thrusters
- Equipped galley
- Four guest cabins with ensuite bathrooms
- Generators
- Hydraulic gangway
- Raymarine Platinum Package (Top of the range)
- Stabilizers
- Tender & Toys
- Triple crew cabin with ensuite bathroom
- TV and hi-fi systems in saloon and all guest cabins
- Washer/dryer
- Watermaker

MANUFACTURER'S BACKGROUND:

The Sanlorenzo shipyard has been building high-quality motor yachts since 1958. It is a boutique firm in the yachting industry, building only a limited number of made-to-measure units per year. Each yacht is designed and produced according to the specific requests, style, and desires of the individual owner.

The shipyard's headquarters are located on the banks of the river Magra, inside the Montemarcello-Magra natural reserve, in Ameglia, in the province of La Spezia, in Liguria, Italy. A second division is based in the Tuscan seaside town of Viareggio, the historic centre of motor yacht manufacturing in Italy, while the production of superyachts is located in the La Spezia shipyard.

BUILDER'S COMMENT:

The entry-level model for Sanlorenzo's planning fleet. It is the only yacht in its category to be made to measure in line with its owner's requests. Many new features are included like a lower gunwale outside the salon to allow more light to enter through the large windows. Owners and guests are given a real feeling of enjoying a home away from home. 25 meters of versatility: The space have been redesigned to combine technological research and seagoing excellence, constant innovation, and finest traditions of Italian savoir-faire.

PRESS REVIEW'S:

Being an entry-level model at 78 feet length overall can only be a good thing for a new yacht. That size means the baby in the

family gets many of her larger sisterships' features. With the Sanlorenzo SL78, the superyacht influence includes a flybridge with square footage similar to some 90- or even 100-footers, an open-plan salon filled with Italian designer décor and a full-beam master suite.

The Italian builder was clearly thinking big on the SL78. Her charcoal-gray flybridge is nearly two-thirds of the yacht's 80-foot-10-inch length overall. And the SL78 Sag Harbor edition has a hydraulic-electric radar arch that folds toward the deck to reduce its height by a good 5 feet. There are also nice design touches, including a glass-walled staircase, louvered sunroof, drop-down swim platform and country kitchen.

This motor yacht is the next generation of the builder's fiberglass planing range, and the SL78 runs well, reaching 29 knots with her twin 1,620 hp MTU 10V 2000 M96L diesels. This yacht looks fast, which makes sense, because she is fast. Plus, she is stable underway and at rest in a chop, thanks to CMC stabilizers. The builder put together what it calls the Raymarine Diamond Edition electronics package, covering everything from GPS and radar to thermal imaging and chirp technology, which makes the SL78 a fairly intuitive vessel to drive, -either by wheel or joystick. Sanlorenzo of the Americas did a comprehensive job of Americanizing its Sag Harbor edition with redundant pumps and U.S. systems, keeping the boat familiar and operational.

Specification

CONSTRUCTION

Hull, Deck & Superstructure Construction:

- Hull and superstructure in composite material
- Main deck and the superstructure in sandwich laminated with a closed cell foam core
- Partial Double bottom hull accommodating grey/ fresh/black water tanks
- Spaced transverse frames and girders, which run longitudinally
- Teak on main deck, swimming platform and flybridge -
- Two watertight bulkheads
- White hull

MACHINERY

Engine & gearbox:

- 2 x 2 x MTU M96L 10V 2000
- Closed circulation freshwater engine cooling via saltwater intake and heat exchanger.
- V-drive gearboxes to shaft drives

Maintenance & Performance:

- Engine hours: 680 approx. as of Summer 2021
- Cruising speed: approx 25 knots
- Maximum speed: approx. 30 knots
- Range approx. 315 Nm @ 25 knots or approx. 400 Nm @ 12 knots
- Fuel consumption: 180 Litres/Hr @ 12 Knots and 450 Litres/Hr @ 25 knots

Propulsion & Steering:

- Hydraulic steering system
- Bow & stern electric 48V thrusters
- CMC Hydraulic fin stabilisers (zero speed and dynamic)

ELECTRICAL SYSTEMS

Voltage systems:

- 24vDC domestic system with 220vAC via shore power, generator or inverter

Battery Banks:

- 30 x 24vDC battery banks for engine & generators starts and services
- 2 x AGM plus 2 x Gel Engine and Generator Starter battery banks

Charging:

- 5 x Mastervolt Battery chargers

Inverter:

- 1 x Mastervolt Inverter
- 1 x Danfoss Inverter

Alternators:

- 2 x engine-mounted alternators

Generator:

- Kohler 26kw 220vAC diesel generator

- Kohler 26kw 220vAC diesel generator
- Generator hours: 560 approx. as of December 2020

Shore Power:

- 220vAC shore power connection
- 220vAC sockets in interior
- USB sockets in all cabins

PLUMBING & GAS SYSTEMS

Fresh Water:

- Water is pressurised by high-pressure Gianneschi and Calpeida pump systems
- Hot & cold freshwater pressurised water supply throughout
- Hot water boiler tanks via 220v immersion heater element.

Watermaker:

- Idromar 180 litre per hour reverse osmosis watermaker

Bilge Pumps:

- Electric bilge pumps
- Manual bilge pump

TANKAGE

Fuel:

- 5,350 litres fuel tank capacity

Fresh Water:

- 1,400 litres water tank capacity

Holding tank:

- 400 litres Black water holding tank
- 350 litres Grey water tank

NAVIGATION & COMMUNICATION EQUIPMENT

At lower helm:

- 3 x AXIOM 16' Plotters
- Autopilot
- Domotic control
- Emergency steering
- other controls
- Radar
- SSB Radio
- Thrusters Joystick control
- Vhf

At flybridge helm:

- 2 x Raymarine colour GPS Radar chart plotter display
- Raymarine autopilot
- Raymarine tridata display
- Steering compass

Communications Equipment:

- VHF with DSC at both helms
- SSB radio

DOMESTIC EQUIPMENT

Galley Equipment:

- Electric cooking plate
- Oven
- Fridge/freezer
- Dishwasher
- 2 x MIELE Washing machine / dryer
- Food waste disposal
- Fridge and icemaker in saloon

Laundry:

- 2 x Washer in the Crew area and Guest area

- 1 x Dryer in the Crew area and Guest area

Heads:

- Electric vacuum flush freshwater heads in all heads
- Sinks and showers with hot & cold-water supply
- Bidets in guest cabins

Heating & Ventilation

- 220vAC Reverse cycle air-conditioning system in all cabins

Entertainment:

- Platinum Package audio / video system (top of the range, with DENON + usb amp and decoder in all cabins)
- Smart TV in each cabin and salon with Satellite receiver.
- Audio system in each cabin and main salon (connected with aft deck) with USB connection and Bluetooth
- 2 x Audio Systems on the bow and flybridge Saloon LCD TV with Hi-Fi
- Owner's cabin TV with Hi-Fi
- VIP cabin TV with Hi-fi
- TV and HI-Fi system in guest cabins
- Sat TV
- Radio / CD / MP3

Security / Onboard communications (mounted on the arch):

- GPS antenna
- Radar antenna
- VHF aerial
- AIS aerial
- WIFI antenna 3G & 4G all through
- SAT antenna with dummy dome
- CCTV system

ACCOMMODATION

Interiors finishing:

- FLY Roda and Paola Lenti furniture
- Interior Parquet antislip flooring
- Basswood slated floor in main deck
- Carpeted floors in guest cabins
- Vinyl floor in the galley and crew area
- Bulkheads and furniture in basswood and oak
- Lacquered white ceilings
- Lacquered wood and Silk Georgette marble restrooms in guest cabins
- Stainless steel porthole mosquito nets (original SANLORENZO)
- LED courtesy lights
- Luxury mattresses
- Bed covers, tablecloths and linens
- Customized beach towels

Summary

- Saloon with "U" leather sofa, coffee table and furniture to portside
- Dining area with table and 8 x chairs
- Hall with door leading to the exterior side passageway and interiors stairs to fly bridge
- Separate galley with door leading to the exterior side passageway
- Wheelhouse with dinette to starboard side and wine cellar
- Owner's cabin amidships with ensuite bathroom and walk-in wardrobe
- Forward VIP cabin with bathroom
- Two guest's cabins with 2 beds and bathrooms
- TECMA Business WC with waterjet hydrobrushes
- Crew cabin at bow with three beds and bathroom

Accommodation Layout from Forwards:

Flybridge:

- Helm station
- C-shape sofa with table
- BBQ on the flybridge
- Music system with radio and CD player with speakers.
- Bar cabinet with icemaker, fridge and grill

- Table with eight chairs

Main deck

Foredeck:

- Bow large sunbathing area with sun cushions

Wheelhouse:

- Door to close and isolate the navigation area
- Central helm wheel
- Leather seating chair
- Wheelhouse leather covered top
- Teak floor
- "L" shaped sofa starboard side with glass table

Galley:

- Fully fitted marble work surface and vinyl floor
- Double stainless-steel sink
- Double door top cupboards
- Industrial fridge and freezer
- Double door lower cupboards
- Lower drawers
- Broggi crockery and cutlery
- ALESSI and Villeroy Bosh dishes service
- Full set of crockery for up to 12 people together with cutlery

Dining area:

- Marble central table accomodating 8
- Wall Mirror
- 8 x chairs
- Light wood floor
- Side lower cupboards
- Electric side curtains
- White gloss ceiling panels

Saloon:

- MINOTTI White leather C-shape sofa to starboard accommodating 8-10
- Lounge dark rounded wood table
- White leather sofa to port
- Side air conditioning fan coil
- Side light wood furniture
- Sliding crystal entrance doors with dark curtains

Aft cockpit:

- Teak wood fixed table accommodating 6/8 persons
- 5 x Exterior chairs rear cockpit seating
- Separate music system with own ceiling mounted speakers
- Teak laid deck

Lower deck

Crew ensuite cabin:

- Crew quarters access from the wheelhouse and from the crew mess
- Twin bulkhead bed to starboard
- Single bed to port side
- 2 x wardrobe

Crew bathroom:

- Large Bathroom with Electric vacuum WC, Shower and washbasin

VIP cabin

- King size bed with lower safety bumper
- Headboard of the bed
- 2 x side bed cabinets with two drawers
- 2 x bed side white light appliques
- 4 x lower double door cupboards
- White gloss ceiling panels
- Flat screen SAT TV
- 1 x side porthole

VIP en-suite bathroom

- Washbasin marble top with mirror
- Electric vacuum WC and bidet
- Shower
- Bathroom cabinet with drawer
- Extractor Fan

Twin cabin

- 2 x single pullman beds with with lower safety bumper
- Central bed cabinets with three drawers and incorporated RADIO / CD
- Ceiling lights
- White gloss ceiling panels

Twin bathroom

- Washbasin marble top with mirror
- Electric vacuum TECMA WC and bidet
- Shower
- Bathroom cabinet with drawer
- Extractor Fan

Full beam Master Cabin:

- King-sized bed with lower dark leather safety bumper
- Headboard of the bed
- Mirror wall over the bed headboard
- 2 x double large portholes
- 4 x Lower cabinet on starboard side
- Light wooden dressing table with independent black leather pouf
- Flat screen SAT TV

Master cabin ensuite bathroom:

- Bathroom fog fume door
- Wash basin on marble top
- Electric vacuum TECMA WC and bidet
- Large shower with bathtub and hydromassage
- Teak floors throughout
- Extractor fan

DECK EQUIPMENT

General:

- Teak with black joints on cockpit, bow area and flybridge
- Hydraulic gangway
- Hydraulic swimming platform
- Tender garage with electric-hydraulic tender launch system
- SUP
- Snorkeling Gear
- Seabob F5
- Waterksky (60 Knots max speed)
- Air compressor

Anchoring & Mooring:

- 1 x anchor windlass 2000 W with capstan
- 1 x 90kg Galvanised steel anchor with 150m of 12mm chain
- Chain washing system
- Whisker anchor in Dyneema with homologated hook
- Two aft electrical capstans 1500W
- Warps & fenders

Covers, Cushions & Canvas:

- Hardtop with blade opening roof on the flybridge
- Closed cell cushions with waterproof fabric
- Waterproof covers for the whole boat furniture and accessories
- Covers for windows
- Aft sundeck mattresses
- Protection covers for all exterior furniture and seating

Tender

- Tender Williams 395 Sport (with optionals)
- Built: 2020

- Power: 90 HP

General Maintenance:

- Engine serviced by official MTU service
- Generator periodical service
- Teak deck maintenance

SAFETY EQUIPMENT

General note on safety equipment: Any safety equipment such as liferafts, Epirbs, fire extinguishers and flares etc. are usually personal to the current owner(s) and if being left on-board as part of the sale of a used vessel may require routine servicing, replacement, or changing to meet a new owners specific needs.

Safety equipment:

- CCTV 5 cameras
- 4 x Raymarine camera system - cockpit and engine room camera
- FLIR thermal night vision camera system
- Life jackets and harnesses
- 2 x Ocean Life raft- Service Due 2021
- 2 x Grab bags Service Due 2021
- Fire extinguisher throughout
- EPIRB
- Smoke alarm detectors
- Fire stop technology
- Interior's steps lights

Viewing arrangements

Lying: La Spezia, Italy

Available to view strictly by appointment

Office Hours Mon- Fri 0900 – 17.00

Saturday by prior appointment

For more information or to arrange a viewing please contact us.

Please Note: Due to the varying locations of our yachts, your travel time and the distances that may be involved, we recommend that you only make arrangements to view if you are actively considering purchase.

Lead Broker: Lucio Pellegrini

Grabau International (Palma)

Tel: +34 675 236 174

Email: lucio@grabauinternational.com



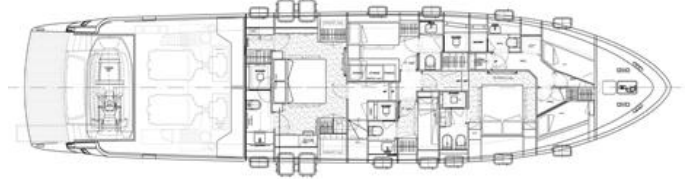
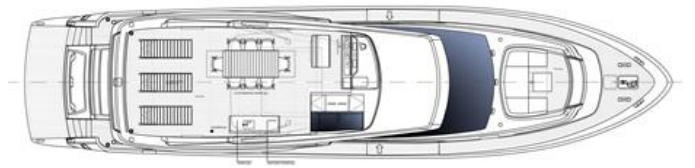

Grabau International offers the details of all vessels in good faith but cannot guarantee or warrant the accuracy of this information or warranty the condition of any vessel and the details do not constitute a part of any contract. A buyer should instruct his agents, or his surveyors, to investigate such details as the buyer desires validated. All vessels are offered subject to prior sale, price change, or withdrawal without notice. Grabau International provides professional yacht conveyancing and legal transfer of title for all yachts as per the ABYA Code of Practice with all deposit payments and final balance payments processed through secure dedicated client accounts solely for that purpose. Our dedicated client accounts are written in trust at Natwest Bank and we are fully insured.