

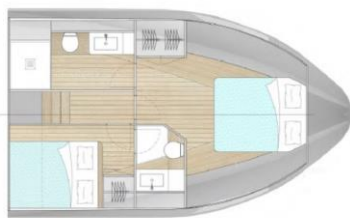

Grabau International (Italia)  
 Via Delle Panche 181, 50141, Firenze Italia  
 Tel: +33 333 7489281  
 Email: [enquiries@grabauinternational.com](mailto:enquiries@grabauinternational.com)  
 Website: [www.grabauinternational.com](http://www.grabauinternational.com)

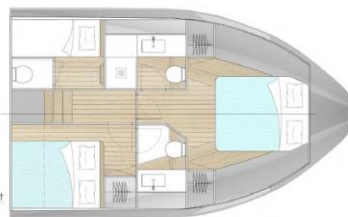

2 cabin layout



2 cabin layout + crew cabin

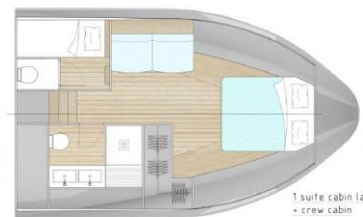

1 suite cabin layout + crew cabin

Yacht Name:	NEW BUILD OPTION	Model:	Forte 50 Rugged Alloy Vessel
LOA:	14.80m / 48.55'	Year:	2019
LWL:	13.20m / 43.30'	Builder:	Siman Srl - Italy
Beam:	3,80 m / 12.46'	Designer:	PGYD
Draft:	0,90 m / 2.95'	Construction:	Aluminium
Displacement:	11,000kgs / 24,250lbs	Accommodation:	2 berth in 1 cabins
Ballast:	-----	Engine:	3x 350hp Petrol Outboard
Location:	La Spezia	Price:	From € 800.000,00 ex Vat

Grabau International offers the details of all vessels in good faith but cannot guarantee or warrant the accuracy of this information or warranty the condition of any vessel and the details do not constitute a part of any contract. A buyer should instruct his agents, or his surveyors, to investigate such details as the buyer desires validated. All vessels are offered subject to prior sale, price change, or withdrawal without notice. Grabau International provides professional yacht conveyancing and legal transfer of title for all yachts as per the ABYA Code of Practice with all deposit payments and final balance payments processed through secure dedicated client accounts solely for that purpose. Our dedicated client accounts are written in trust at Natwest Bank and we are fully insured.

## INTRODUCTION:

Conceived as a development of the Italian Navy's latest C1690 design for a fast offshore patrol boat, the new Forte 50 is a 14.8m all-weather planing motor yacht constructed in aluminium in La Spezia, Italy by Siman Srl, the renowned Italian shipyard with decades of experience in the construction of work vessels for the navy. The new Forte 50 embraces the strong and raw features of a reliable fast craft without any compromise in terms of easy usability and handling.

Available with a variety of luxury internal configurations and powered by triple 350hp outboard engines, the Forte 50 brings her extreme-seakeeping abilities to the realm of luxury leisure yachting. With the option of configuring to RCD Cat A (extremely unusual in this style of boat), her capabilities are clear to see.

## BUILDER OVERVIEW:

From 1988 Siman Srl has been a leading builder of all the metal hull and construction for the most important Italian superyachts brands. Thanks to its long-lasting relationship with the most famous Italian based builder and an active role in developing, building and launching services and military vessels for the Italian authorities (Marina Militare, Vigili del Fuoco e Capitaneria di Porto), Siman's day to day work is focused on developing technology and quality made for reliability.

Siman is always focused on developing a production process which is compliance with the most important quality rules: UNI EN ISO 9001:2015 for the "risk based thinking" model, the UNI EN ISO 14001:2015 for a process with a green environment impact and the BS OHSAS 18001:2007 for an occupational health and safety management system. All of this makes Siman Srl the leading shipyard in Italy for design and construction of aluminium and steel boats.

## DESIGNER OVERVIEW:

Paolo Giordano worked with some of the most important naval Italian naval architect such as Arch. Andrea Vallicelli. Not yet completed his studies he designed and built his first boat, the Velvet 430. He founded PGYD in 2012, with the aim of developing and promoting new ideas in the field of design, always thinking "out of the box". The office is based in Viareggio, Tuscany, in the heart of the nautical world.

Design out of the box means to think differently, from a new perspective. It's a thinking process which aims to translate unconventionally relational reasoning and thinking. Each design is developed following this design approach, looking always innovative solutions in aesthetic and functional terms, with technical rigor and formal coherence.

Paolo has a huge portfolio of custom made projects between 10 and 25 metres and he is now also an inspired designer in the Superyacht market.

## CONSTRUCTION:

Siman has continually strived to improve its technologies and its construction processes in a way to optimize the relationship between delivery time and the quality of the final product.

The construction of any Siman-built yacht starts after a very important process spent to define every design detail, construction process, logistic analysis and planning in way to reduce or eliminate problems during the construction and so obtain a very high quality final product and respecting delivery time.

The Forte 50 hull is characterised by her construction in aluminium 5083, a very high quality material required by the most important Certification Society of the World for the naval construction. Aluminium

Grabau International offers the details of all vessels in good faith but cannot guarantee or warrant the accuracy of this information or warranty the condition of any vessel and the details do not constitute a part of any contract. A buyer should instruct his agents, or his surveyors, to investigate such details as the buyer desires validated. All vessels are offered subject to prior sale, price change, or withdrawal without notice. Grabau International provides professional yacht conveyancing and legal transfer of title for all yachts as per the ABYA Code of Practice with all deposit payments and final balance payments processed through secure dedicated client accounts solely for that purpose. Our dedicated client accounts are written in trust at Natwest Bank and we are fully insured.

5083 is a fantastic material in term of mechanical properties and low weight. Compared to Steel or GRP solid hull construction, aluminium permits a reduction in the final displacement by reducing the weight of the hull and superstructure and in consequence reducing the maximum power required of the engines to maintain the desired maximum speed.

All the plates and all the components defining the hull structure are created by CAD/CAM and then produced with a CNC plasma cutting machine before being welded by Siman technicians in a particular sequence defined by Siman engineers designed to optimize the construction process. Every single component defining the hull and the superstructure is part of a composite puzzle to obtain the final geometry of the hull and superstructure. All the Siman hulls are then coated with anticorrosive paint, before the final finishing treatment, to ensure maximum resistance to corrosion during the life of the yacht.

During the installation of plumbing and mechanical components, the Siman technicians are supported by technical drawings obtained by 2D and 3D CAD Software to eliminate the possibility of interferences and problems. Like the assembly of the hull, every component of the plumbing and mechanical systems are installed following sequences planned by Siman engineers in way to optimize the delivery time. Even during the construction the boat weight and the position of the centre of mass is monitored and controlled regularly by using certificated load cells in way to respect the design parameters.

## STANDARD EQUIPMENT

### RCD STATUS:

- The yacht conforms with the essential safety requirements of Directive 94/25EC (Recreational Craft Directive) – Cat. B.
- Category A compliancy available on request

### HULL, DECK & SUPERSTRUCTURE CONSTRUCTION:

- Full construction in 5083 aluminium alloy. This grade of aluminium alloy is highly resistant to attack by seawater and industrial chemicals and remains exception strength after welding. It has the highest strength of the non-heat treatable alloys.
- Hull and superstructure painted white – different paint finishes available on request.
- Teak laid decking in the cockpit
- Sliding structure providing a structural bimini over the main cockpit area

### ENGINES:

- 3x 350hp 4-stroke petrol outboard engines offered as standard – Alternative engine configurations available on request

### STEERING:

- Fully hydraulic power-assisted steering system
- Trim tabs with electro-hydraulic controls

## ELECTRIAL SYSTEMS

### AC/DC system

- 24vDC primary domestic system with 12vDC starting circuit and 220v AC via shorepower
- 220vAC sockets in each cabin

### BATTERY BANKS:

- 12vDC service batteries joined in parallel and series to supply @ 24vDC
- 3x 12vDc Engines start batteries

Grabau International offers the details of all vessels in good faith but cannot guarantee or warrant the accuracy of this information or warranty the condition of any vessel and the details do not constitute a part of any contract. A buyer should instruct his agents, or his surveyors, to investigate such details as the buyer desires validated. All vessels are offered subject to prior sale, price change, or withdrawal without notice. Grabau International provides professional yacht conveyancing and legal transfer of title for all yachts as per the ABYA Code of Practice with all deposit payments and final balance payments processed through secure dedicated client accounts solely for that purpose. Our dedicated client accounts are written in trust at Natwest Bank and we are fully insured.

## CHARGING / INVERTER:

- Automatic battery charger

## Galley

- Galley with ample counter space
- Stainless steel 3-burner gas hob with oven
- Sink with mixer tap
- Front opening fridge plus freezer

## Fresh Water:

- Pressurised hot and cold fresh water supplies
- Stern shower integrated the cockpit

## BILGE PUMPS:

- 24vDC electric bilge pump with alarm in the cockpit
- 2x Manual bilge pumps (engine room and cabin)

## TANKAGE

## Fuel:

- 900 litres fuel tank capacity in stainless steel tanks

## Fresh Water:

- 500 litres water tank capacity

## Holding Tanks:

- Black and grey water tanks

## NAVIGATION &amp; COMMUNICATION EQUIPMENT

- Colour LCD GPS chartplotter
- Autopilot with rotary control head unit
- Steering compass
- Further navigation instrumentation packages available on request

## Communications Equipment:

- VHF with external speaker

## ACCOMMODATION

- The standard interior configuration includes a master cabin with ensuite heads, a further double guest cabin and a separate day heads.
- Two alternative layouts are available on request.
- The first alternative cabin layout consists of a double master cabin with ensuite heads/shower, a further double guest cabin with ensuite heads/shower and a single crew cabin with ensuite heads.
- The second alternative cabin layout consists of one large master cabin with large ensuite heads/shower and one single crew cabin with ensuite heads.

Grabau International offers the details of all vessels in good faith but cannot guarantee or warrant the accuracy of this information or warranty the condition of any vessel and the details do not constitute a part of any contract. A buyer should instruct his agents, or his surveyors, to investigate such details as the buyer desires validated. All vessels are offered subject to prior sale, price change, or withdrawal without notice. Grabau International provides professional yacht conveyancing and legal transfer of title for all yachts as per the ABYA Code of Practice with all deposit payments and final balance payments processed through secure dedicated client accounts solely for that purpose. Our dedicated client accounts are written in trust at Natwest Bank and we are fully insured.

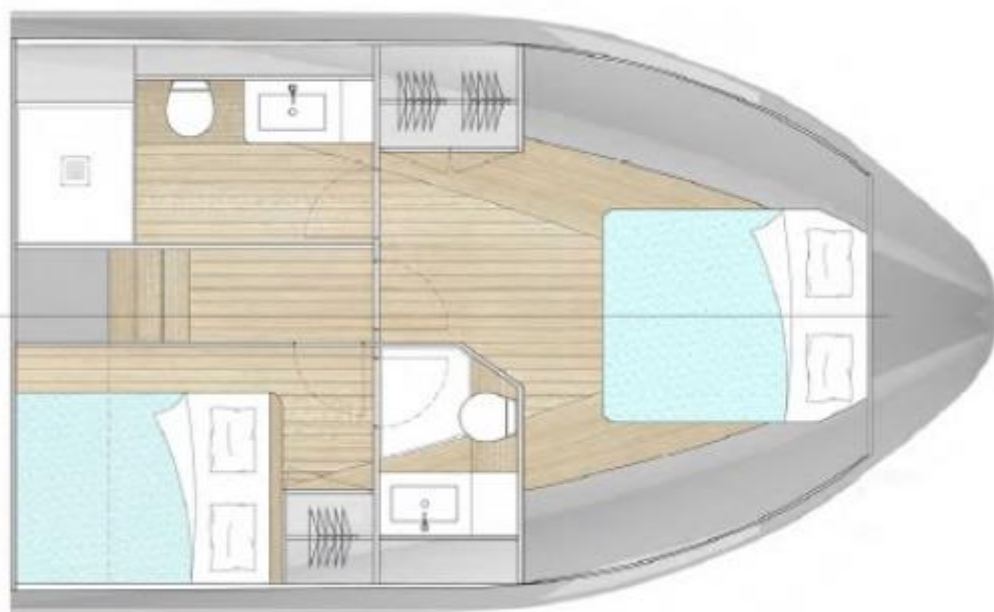

2 cabin layout

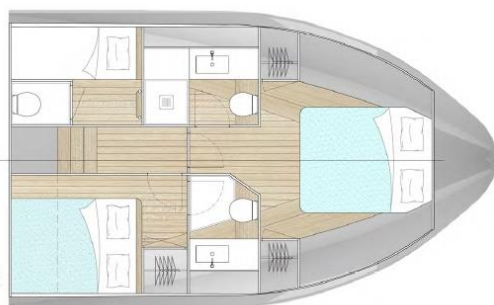

2 cabin layout  
+ crew cabin

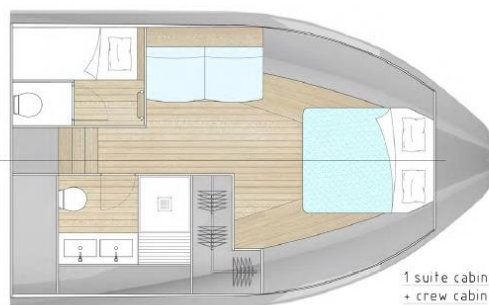

1 suite cabin layout  
+ crew cabin

Standard Cabin Layout in further detail:

Master Cabin:

- Custom double mattress
- Leather trim around bed with stitching
- Leather sideboard, ceiling and headboard panels
- Storage areas and under bed
- Lacquer finished wall panels
- Lacquer finished furniture with varnished wood trim
- Stainless steel hardware
- LED lighting with strip lights and reading lamps

Grabau International offers the details of all vessels in good faith but cannot guarantee or warrant the accuracy of this information or warranty the condition of any vessel and the details do not constitute a part of any contract. A buyer should instruct his agents, or his surveyors, to investigate such details as the buyer desires validated. All vessels are offered subject to prior sale, price change, or withdrawal without notice. Grabau International provides professional yacht conveyancing and legal transfer of title for all yachts as per the ABYA Code of Practice with all deposit payments and final balance payments processed through secure dedicated client accounts solely for that purpose. Our dedicated client accounts are written in trust at Natwest Bank and we are fully insured.

- Skyscreen for deckhead hatch
- Wood flooring

#### Lounge Area:

- Custom sofa with leather trim and cushions
- Leather sideboard and ceiling panels
- Mini galley area with refrigerator and storage
- Stainless steel handrail to cockpit
- Stainless steel hardware
- LED lighting
- Wood flooring

#### Guest Cabin:

- Custom mattresses
- Leather trim around bed with stitching
- Leather sideboard, ceiling and headboard panels
- Storage under bed and staircase
- Lacquer finished wall panels
- Lacquer finished furniture
- Stainless steel hardware
- LED lighting with strip lights and reading lamps
- Wood flooring

#### Head & Shower:

- Teak flooring in heads and shower
- Lacquer finished furniture with varnished wood trim
- Lacquer finished wall and ceiling panels
- Mirror
- Electric heads
- Facet
- Shower
- Tempered glass shower door
- Stainless steel hardware
- LED lighting
- Storage areas

#### DECK EQUIPMENT:

Grabau International offers the details of all vessels in good faith but cannot guarantee or warrant the accuracy of this information or warranty the condition of any vessel and the details do not constitute a part of any contract. A buyer should instruct his agents, or his surveyors, to investigate such details as the buyer desires validated. All vessels are offered subject to prior sale, price change, or withdrawal without notice. Grabau International provides professional yacht conveyancing and legal transfer of title for all yachts as per the ABYA Code of Practice with all deposit payments and final balance payments processed through secure dedicated client accounts solely for that purpose. Our dedicated client accounts are written in trust at Natwest Bank and we are fully insured.

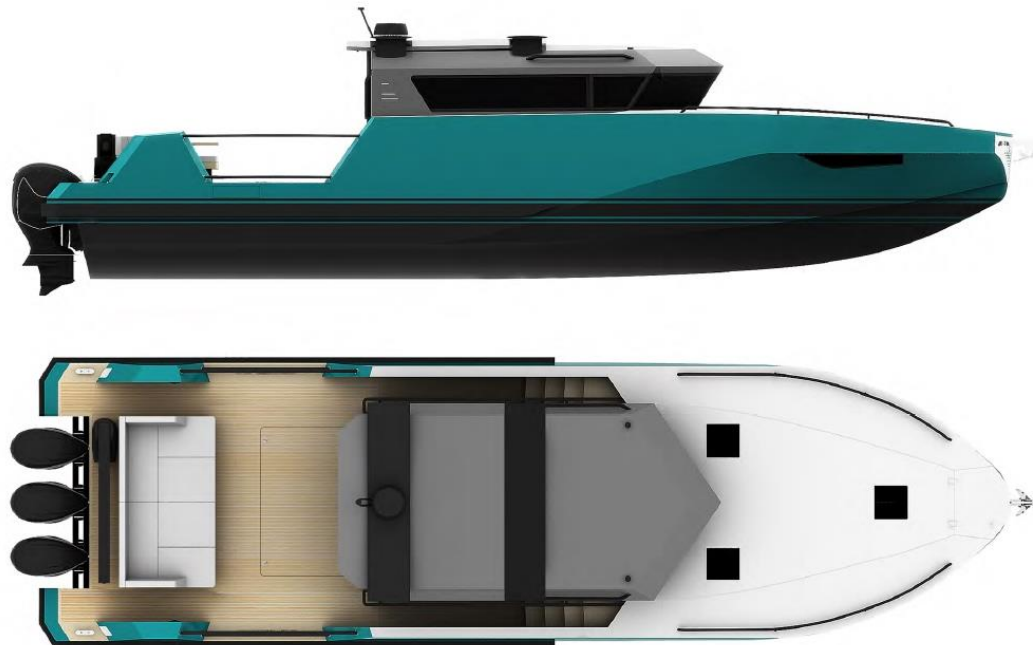

#### General:

- Manual foldable swimming ladder
- Side boarding gates
- Folding teak cockpit tables

#### Anchoring:

- Integrated anchor launching system in bow
- 20 kgs Delta anchor with 50 m galvanised 10mm anchor chain

#### OPTIONAL EXTRAS:

- Sidepower 12vDC bowthruster
- 220vDC Generator with dedicated 12vDC start battery
- 4-burner 220vAC electric hob.
- Panasonic microwave convection oven.
- Cockpit BBQ
- CruiseAir 220vAC reverse-cycle air-conditioning system with outlets and controls throughout interior plus further control and outlet in cockpit.
- Bose HI-FI.
- LCD TV.
- Davits in the cockpit for watertoy storage.
- Crane for watertoys
- Safety equipment.
- Stern gangway and Front step-ladder
- Hydraulic retractable swimming ladder
- Electric sliding side windows
- Crane for toys
- Sliding rear door from door
- Custom sliding roof
- Military seats

Grabau International offers the details of all vessels in good faith but cannot guarantee or warrant the accuracy of this information or warranty the condition of any vessel and the details do not constitute a part of any contract. A buyer should instruct his agents, or his surveyors, to investigate such details as the buyer desires validated. All vessels are offered subject to prior sale, price change, or withdrawal without notice. Grabau International provides professional yacht conveyancing and legal transfer of title for all yachts as per the ABYA Code of Practice with all deposit payments and final balance payments processed through secure dedicated client accounts solely for that purpose. Our dedicated client accounts are written in trust at Natwest Bank and we are fully insured.

## PHOTOS AND DIAGRAMS

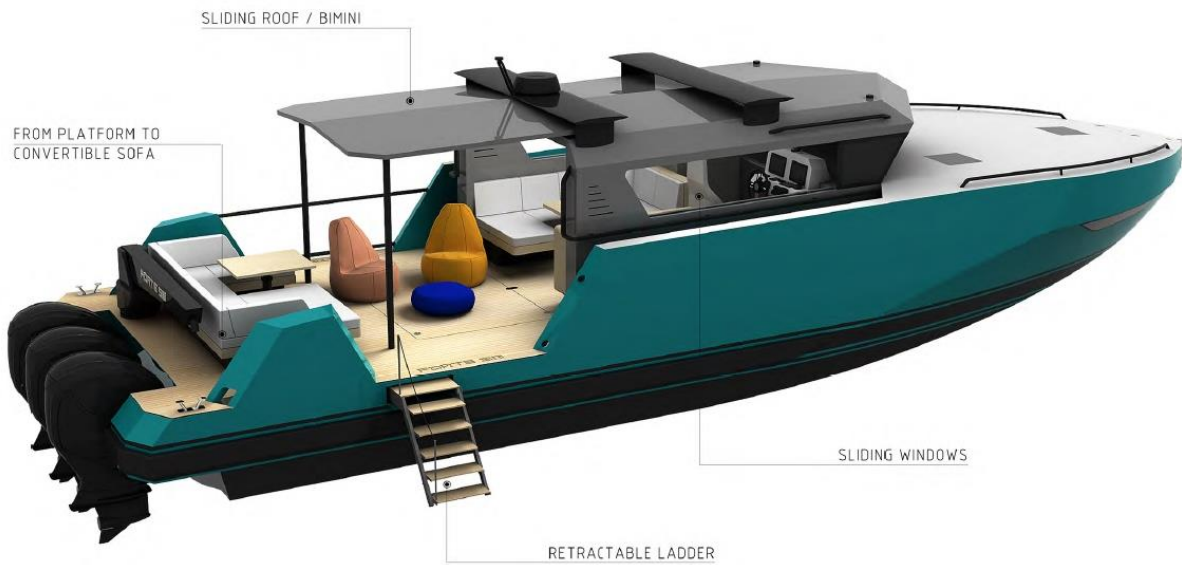

Grabau International offers the details of all vessels in good faith but cannot guarantee or warrant the accuracy of this information or warranty the condition of any vessel and the details do not constitute a part of any contract. A buyer should instruct his agents, or his surveyors, to investigate such details as the buyer desires validated. All vessels are offered subject to prior sale, price change, or withdrawal without notice. Grabau International provides professional yacht conveyancing and legal transfer of title for all yachts as per the ABYA Code of Practice with all deposit payments and final balance payments processed through secure dedicated client accounts solely for that purpose. Our dedicated client accounts are written in trust at Natwest Bank and we are fully insured.